

WALL MOUNTED FITTINGS WITH 90° VALVES FOR EXPOSED PIPING

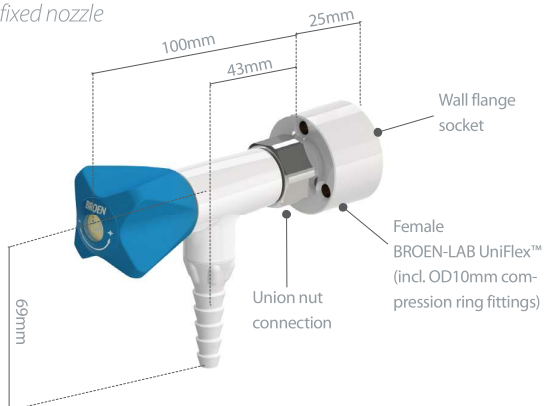

BROEN-LAB UNIFLEX™ FITTINGS FOR NON-BURNING 2.0 GASES / VACUUM

With fixed nozzle



With quick release coupling



SPECIFICATIONS

Handle: Plastic, media indication according to EN13792

Hose nozzle: Plastic, fixed (can be unscrewed by hand, thread: male G3/8)

NON-BURNING 2.0 GASES **VACUUM / HIGH FLOW**

Headwork: Needle

Headwork: High flow

Opening/closing function: 3 x 360°

Opening/closing function: 1.5 x 360°

Max. working pressure: 16 bar / 232 psi

Working pressure: -1 bar to 16 bar / -14.5 psi to 232 psi

Allowable test pressure after installation:

1.5 x max working pressure without function of the valve

MATERIALS WITH MEDIA CONTACT

Metals: Brass

Plastics: PVDF, PP, SPX (hose)

Sealing: FKM

Lubricant: Perfluoropolyether based









ORDERING INFORMATION

For standard configuration please refer to the item numbers below.

Other options:

- different media
- removable plastic hose nozzle with union nut
- disability-friendly handle
- micro flow headwork (for 2.0 non-burning gases)
- high flow headwork (for 2.0 non-burning gases)
- other inlet options (hose or compression ring fittings)
- wall flange socket for built-in installation

Models

Media	 with fixed nozzle	 with hexagon coded quick release coupling
 Compressed air	2530 177 1021-T	2530 179 1021-T
 Nitrogen	2530 177 1023-T	2530 179 1023-T
 Carbon dioxide	2530 177 1024-T	2530 179 1024-T
 Argon	2530 177 1025-T	2530 179 1025-T
 Helium	2530 177 1026-T	2530 179 1026-T
 Low vacuum (1000 to 1 mbar)	2530 178 1028-T	2530 180 1028-T

Delivered with wall flange socket and compression ring fitting for OD10mm Cu-pipe
For other options please refer to pages 18-19 or contact your local BROEN-LAB representative.

WALL MOUNTED FITTINGS WITH STRAIGHT VALVES FOR EXPOSED PIPING



With fixed nozzle

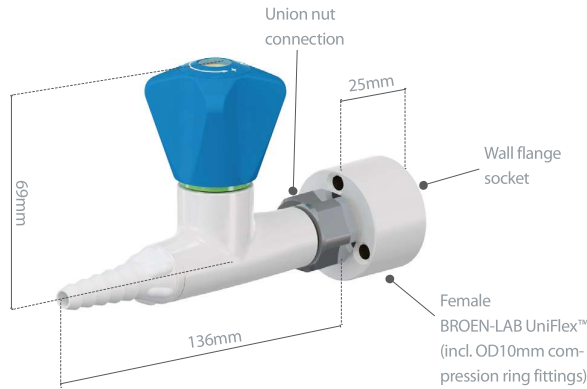

With quick release coupling

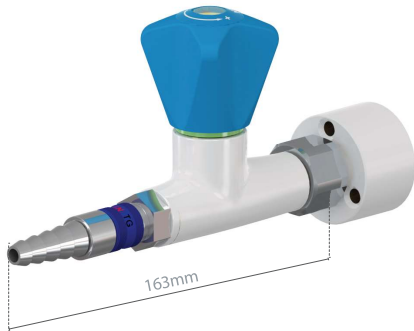

SPECIFICATIONS

Handle: Plastic, media indication according to EN13792

Hose nozzle: Plastic, fixed (can be unscrewed by hand, thread: male G3/8)

NON-BURNING 2.0 GASES **VACUUM / HIGH FLOW**

Headwork: Needle

Headwork: High flow

Opening/closing function: 3 x 360°

Opening/closing function: 1.5 x 360°

Max. working pressure: 16 bar / 232 psi

Working pressure: -1 bar to 16 bar / -14.5 psi to 232 psi

Allowable test pressure after installation:

1.5 x max working pressure without function of the valve

MATERIALS WITH MEDIA CONTACT

Metals: Brass

Plastics: PVDF, PP, SPX (hose)

Sealing: FKM

Lubricant: Perfluoropolyether based

ORDERING INFORMATION

For standard configuration please refer to the item numbers below.

Other options:

- different media
- removable plastic hose nozzle with union nut
- disability-friendly handle
- micro flow headwork (for 2.0 non-burning gases)
- high flow headwork (for 2.0 non-burning gases)
- other inlet options (hose or compression ring fittings)
- wall flange socket for built-in installation

Models

Media	with fixed nozzle	with hexagon coded quick release coupling
Compressed air	2532 110 1021-T	2532 118 1021-T
Nitrogen	2532 110 1023-T	2532 118 1023-T
Carbon dioxide	2532 110 1024-T	2532 118 1024-T
Argon	2532 110 1025-T	2532 118 1025-T
Helium	2532 110 1026-T	2532 118 1026-T
Low vacuum (1000 to 1 mbar)	2532 117 1028-T	2532 119 1028-T

Delivered with wall flange socket and compression ring fitting for OD10mm Cu-pipe

For other options please refer to pages 18-19 or contact your local BROEN-LAB representative.

BROEN-LAB UNIFLEX™ FITTINGS FOR NON-BURNING 2.0 GASES / VACUUM

90° valve

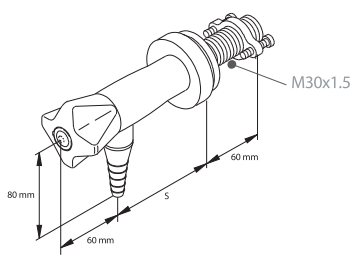

45° valve

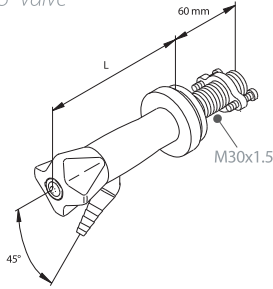

Straight valve

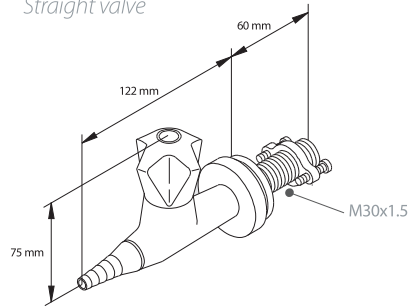

Models: 90° valve, S=50mm



SPECIFICATIONS

Handle: Plastic with media indication according to EN13792
Hose nozzle: Plastic, fixed (can be unscrewed by hand, thread: male G3/8) or quick release coupling (hexagon coded)
Allowable test pressure after installation: 1.5 x max working pressure without function of the valve

NON-BURNING 2.0 GASES	VACUUM / HIGH FLOW
Headwork: Needle	Headwork: High flow
Opening/closing function: 3 x 360°	Opening/closing function: 1.5 x 360°
Max. working pressure: 16 bar / 232 psi	Working pressure: -1 bar to 16 bar / -14.5 psi to 232 psi

MATERIALS WITH MEDIA CONTACT

Metals: Brass
 Plastics: PVDF, PP (hose nozzle)
 Sealing: FKM
 Lubricant: Perfluoropolyether based

BROEN-LAB UNIFLEX™ FITTINGS FOR NON-BURNING 2.0 GASES / VACUUM

Media	with fixed nozzle	with hexagon coded quick release coupling
Compressed air	2530 311 1021-52B	2530 313 1021-52B
Nitrogen	2530 311 1023-52B	2530 313 1023-52B
Carbon dioxide	2530 311 1024-52B	2530 313 1024-52B
Argon	2530 311 1025-52B	2530 313 1025-52B
Helium	2530 311 1026-52B	2530 313 1026-52B
Low vacuum (1000 to 1 mbar)	2530 312 1028-52B	2530 314 1028-52B

Fittings are delivered with a 700mm SPX hose with OD10mm inlet connecton.
 For other options please refer to page 23 or contact your local BROEN-LAB representative.

Models: 90° valve, S=75mm



Media	with fixed nozzle	with hexagon coded quick release coupling
Compressed air	2530 305 1021-52B	2530 308 1021-52B
Nitrogen	2530 305 1023-52B	2530 308 1023-52B
Carbon dioxide	2530 305 1024-52B	2530 308 1024-52B
Argon	2530 305 1025-52B	2530 308 1025-52B
Helium	2530 305 1026-52B	2530 308 1026-52B
Low vacuum (1000 to 1 mbar)	2530 306 1028-52B	2530 309 1028-52B

Fittings are delivered with a 700mm SPX hose with OD10mm inlet connecton.
 For other options please refer to page 23 or contact your local BROEN-LAB representative.

Models: straight valve



Media	with fixed nozzle	with hexagon coded quick release coupling
Compressed air	2532 192 1021-52B	2532 186 1021-52B
Nitrogen	2532 192 1023-52B	2532 186 1023-52B
Carbon dioxide	2532 192 1024-52B	2532 186 1024-52B
Argon	2532 192 1025-52B	2532 186 1025-52B
Helium	2532 192 1026-52B	2532 186 1026-52B
Low vacuum (1000 to 1 mbar)	2532 178 1028-52B	2532 201 1028-52B

Fittings are delivered with a 700mm SPX hose with OD10mm inlet connection.
For other options please refer to page 23 or contact your local BROEN-LAB representative.

Models: 45° valve, L=115mm



Media	with fixed nozzle	with hexagon coded quick release coupling
Compressed air	2530 361 1021-52B	2530 363 1021-52B
Nitrogen	2530 361 1023-52B	2530 363 1023-52B
Carbon dioxide	2530 361 1024-52B	2530 363 1024-52B
Argon	2530 361 1025-52B	2530 363 1025-52B
Helium	2530 361 1026-52B	2530 363 1026-52B
Low vacuum (1000 to 1 mbar)	2530 362 1028-52B	2530 364 1028-52B

Fittings are delivered with a 700mm SPX hose with OD10mm inlet connection.
For other options please refer to page 23 or contact your local BROEN-LAB representative.

Models: 45° valve, L=140mm



Media	with fixed nozzle	with hexagon coded quick release coupling
Compressed air	2530 357 1021-52B	2530 359 1021-52B
Nitrogen	2530 357 1023-52B	2530 359 1023-52B
Carbon dioxide	2530 357 1024-52B	2530 359 1024-52B
Argon	2530 357 1025-52B	2530 359 1025-52B
Helium	2530 357 1026-52B	2530 359 1026-52B
Low vacuum (1000 to 1 mbar)	2530 358 1028-52B	2530 360 1028-52B

Fittings are delivered with a 700mm SPX hose with OD10mm inlet connection.
For other options please refer to page 23 or contact your local BROEN-LAB representative.

BROEN-LAB UNIFLEX™ FITTINGS FOR NON-BURNING 2.0 GASES / VACUUM